



05315200 - LT-S BMT75 BD ER40F H70

| | |
|------------------------------|---|
| Tipo | LT-S Portautensili dritto |
| Attacco | BMT 75 BIG DRIVE |
| Uscita utensile | Portapinza ER 40 F - ghiera interna |
| Raffreddamento | Refrigerazione esterna |
| Senso di rotazione | r1  r2  |
| Velocità max [1/min] | 4000 |
| Coppia max [Nm] | 100 |
| Rapporto | 1:1 |
| H [mm] | 70 |
| Accessori | N.D. |
| Note | N.D. |
| Note per il montaggio | N.D. |



Verificare sempre gli ingombri del portautensile in torretta

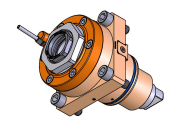
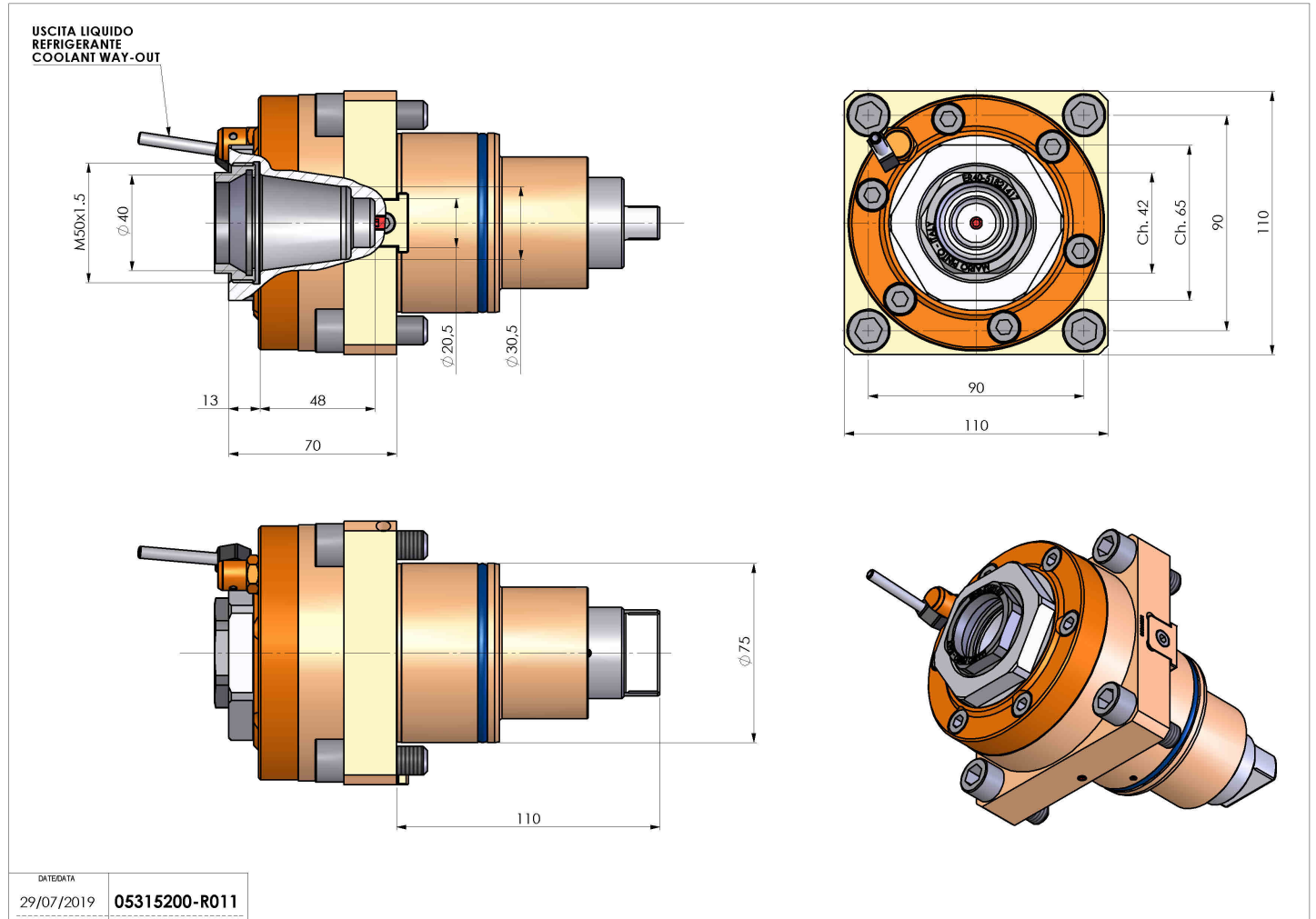

Salvo modifiche tecniche