



## 05255700 - LT-S VDI40ER32FRFOFS50H105 MZH

|                              |   |
|------------------------------|---|
| <b>Tipo</b>                  | LT-S OFS<br>Portautensili dritto offset   |
| <b>Attacco</b>               | VDI 40  |
| <b>Uscita utensile</b>       | Portapinza ER 32 F - ghiera interna   |
| <b>Raffreddamento</b>        | Refrigerazione interna  |
| <b>Offset [mm]</b>           | 50  |
| <b>Senso di rotazione</b>    | r1  r2  |
| <b>Velocità max [1/min]</b>  | 6000  |
| <b>Coppia max [Nm]</b>       | 63  |
| <b>Rapporto</b>              | 1:1   |
| <b>H [mm]</b>                | 105   |
| <b>Pressione max [bar]</b>   | 20  |
| <b>Accessori</b>             | N.D.  |
| <b>Note</b>                  | N.D.  |
| <b>Note per il montaggio</b> | Solo per mandrino secondario  |

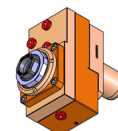

**ATTENZIONE: VERIFICARE L'ORIENTAMENTO DELLA DENTATURA VDI**

Verificare sempre gli ingombri del portautensile in torretta

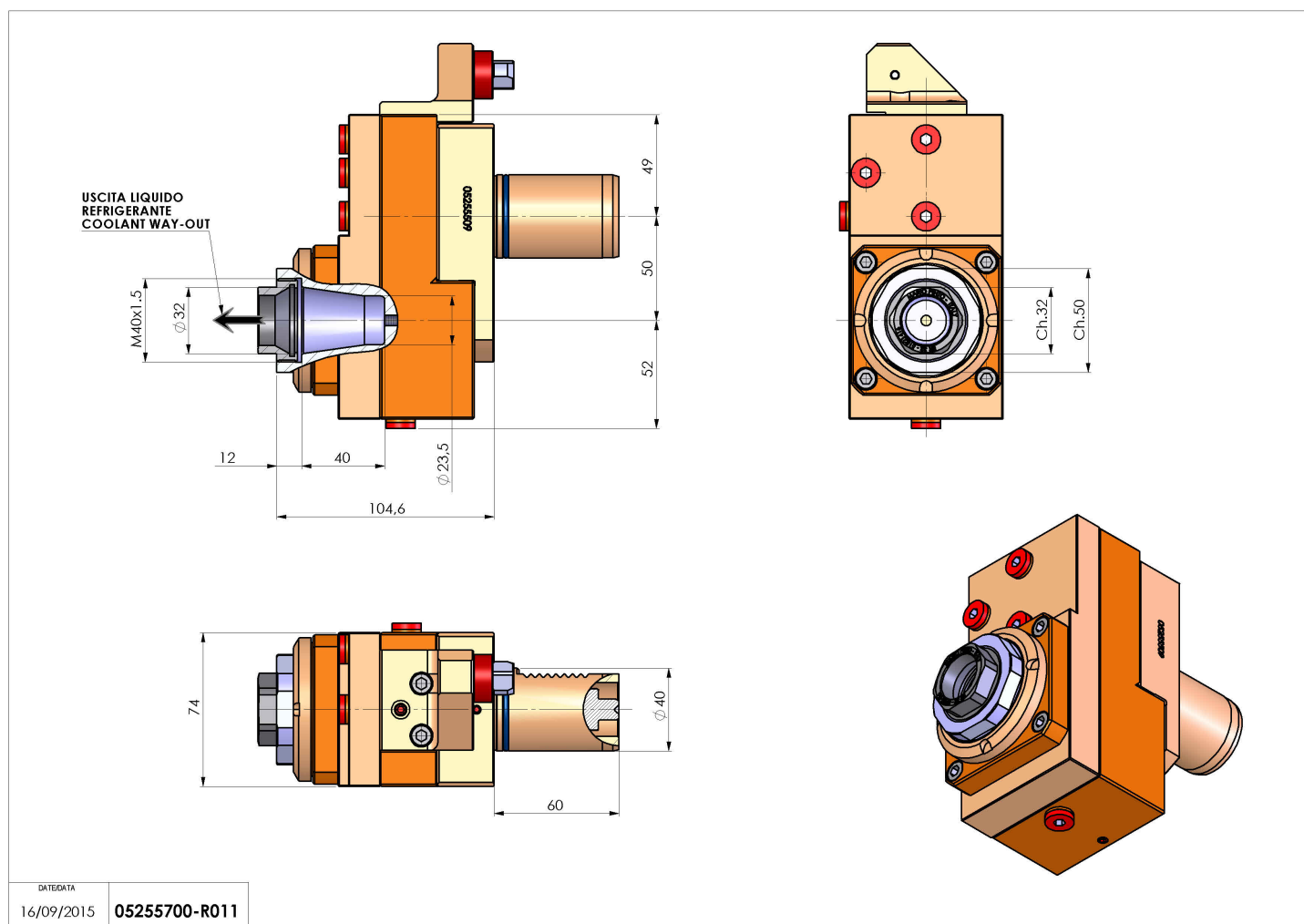

DATE/ATA  
16/09/2015 **05255700-R011**

Salvo modifiche tecniche