

05236200 - LT-S BMT55EM ER32F RF H60

| | |
|-----------------------|-----------------------------------|
| Type | LT-S Tool holder straight |
| Mounting | BMT 55 EM |
| Tool output | Collet nut ER 32 F - internal nut |
| Coolant | Internal coolant |
| Direction of rotation | r1 ↻ r2 ↻ |
| Max speed [rpm] | 6000 |
| Max torque [Nm] | 60 |
| Ratio | 1:1 |
| H [mm] | 60 |
| Max pressure [bar] | 20 |
| Accessories | N.A. |
| Notes | N.A. |
| Mounting tips | N.A. |

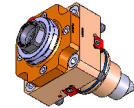

Always check live tool dimensions on the turret

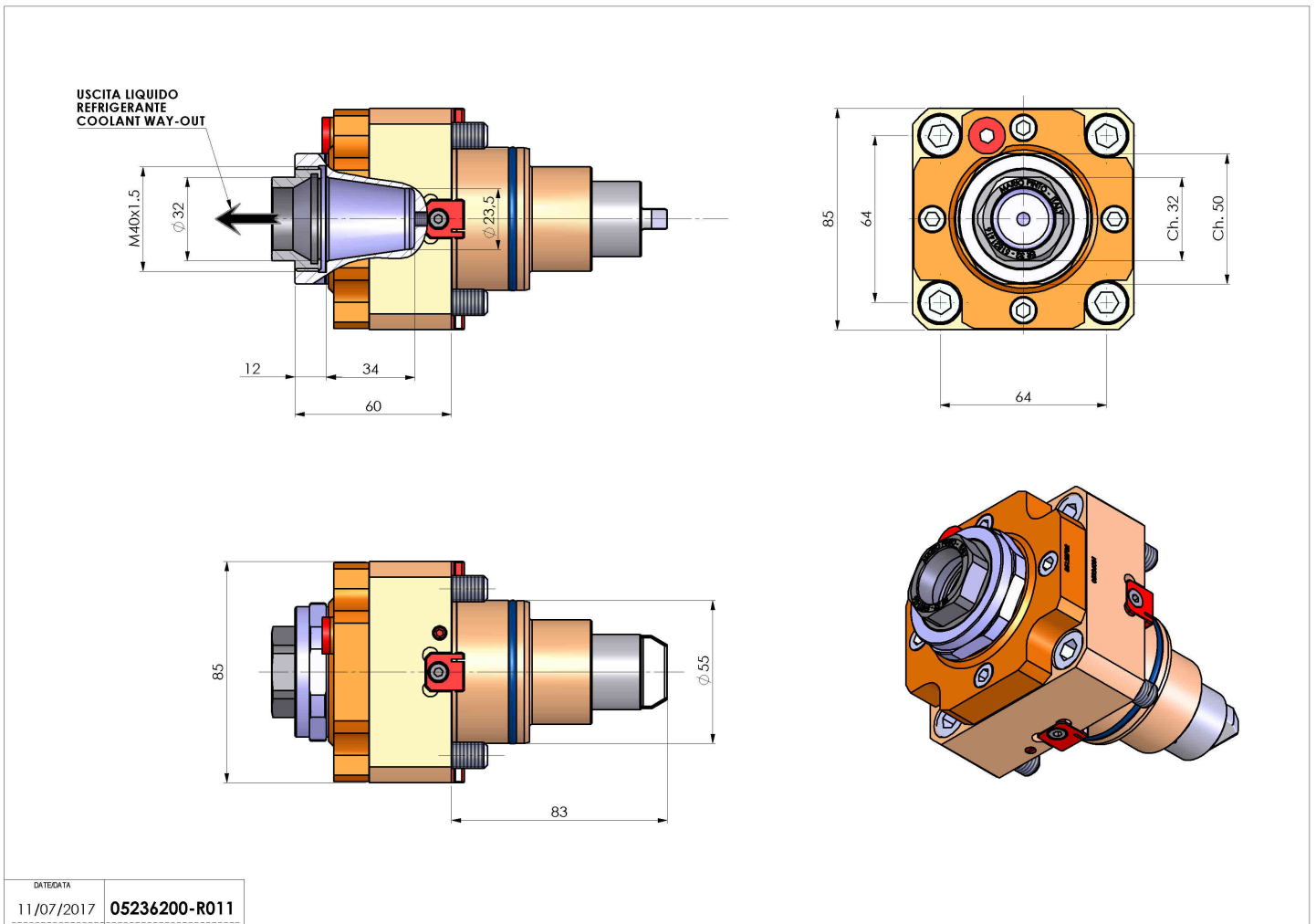

| | |
|------------|---------------|
| DATE/DATE | 05236200-R011 |
| 11/07/2017 | |

Subject to technical changes