

05358000 - LT-HOB-SAW VDI40 2,5:1 H125

| | |
|-----------------|---------------------------------------|
| Type | LT-HOB-SAW Hobbing/tool holder saw |
| Mounting | VDI 40 |
| Tool output | Shank kit Ø16-Ø22-Ø27 |
| Coolant | External coolant |
| Max speed [rpm] | in 6000 / out 2400 |
| Max torque [Nm] | in 60 / out 150 |
| Ratio | 2,5:1 |
| H [mm] | 125 |
| H1 [mm] | 40 |
| Accessories | N.A. |
| Notes | N.A. |
| Mounting tips | N.A. |

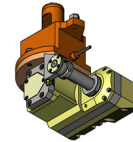

ATTENTION: CHECK THE ORIENTATION OF THE VDI TEETH

Always check live tool dimensions on the turret

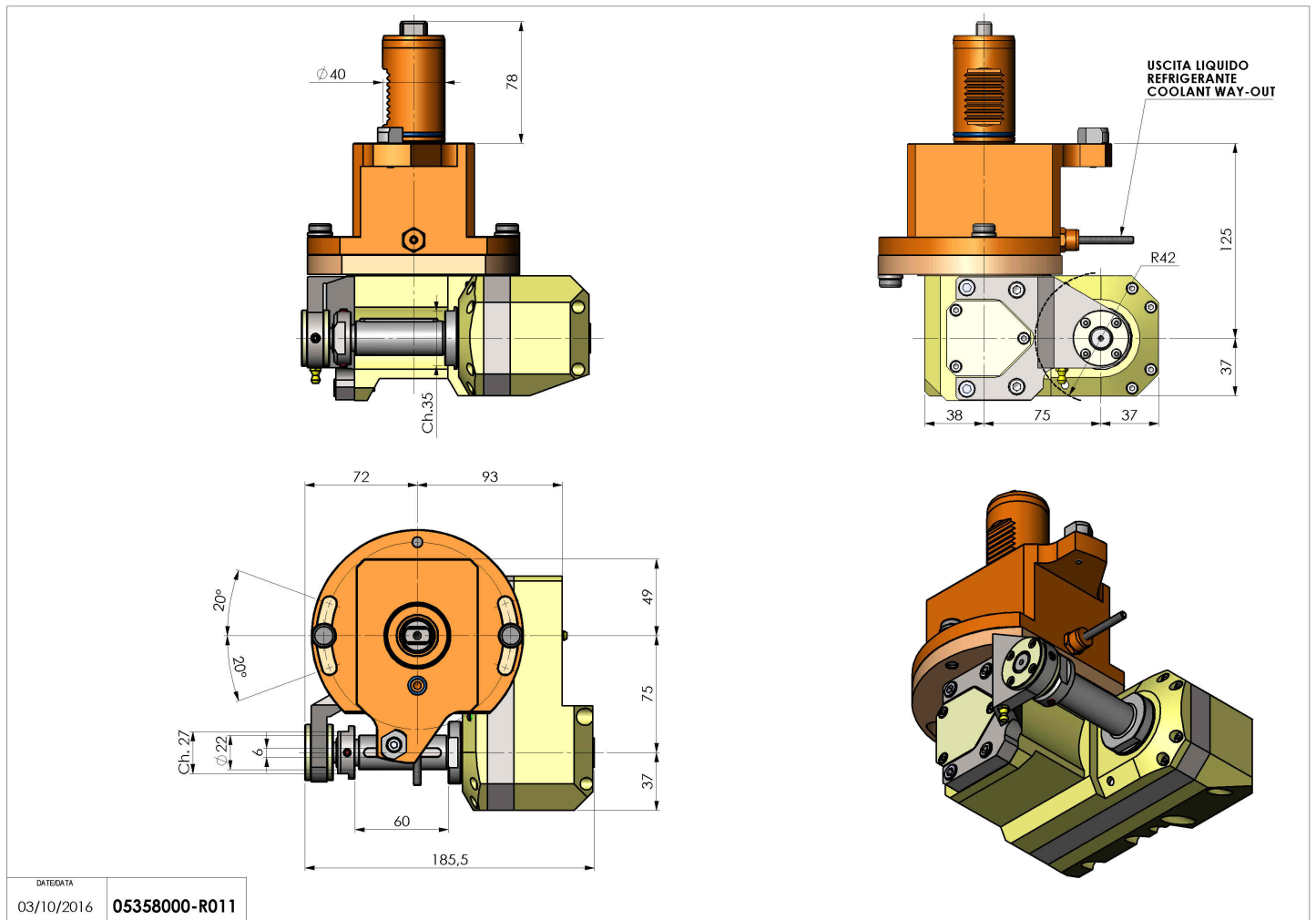

| | | |
|-----------|------------|---------------|
| DATE/DATA | 03/10/2016 | 05358000-R011 |
|-----------|------------|---------------|

Subject to technical changes