

## 05180100 - LT-S VDI40 ER32 H92 DIN5482

|                       |                              |
|-----------------------|------------------------------|
| Type                  | LT-S<br>Tool holder straight |
| Mounting              | VDI 40                       |
| Tool output           | Collet nut ER 32             |
| Coolant               | External coolant             |
| Direction of rotation | r1 ↻ r2 ↻                    |
| Max speed [rpm]       | 6000                         |
| Max torque [Nm]       | 63                           |
| Ratio                 | 1:1                          |
| H [mm]                | 92                           |
| Accessories           |                              |
| Notes                 | N.A.                         |
| Mounting tips         | N.A.                         |

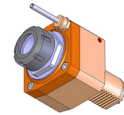

**ATTENTION: CHECK THE ORIENTATION OF THE VDI TEETH**

Always check live tool dimensions on the turret

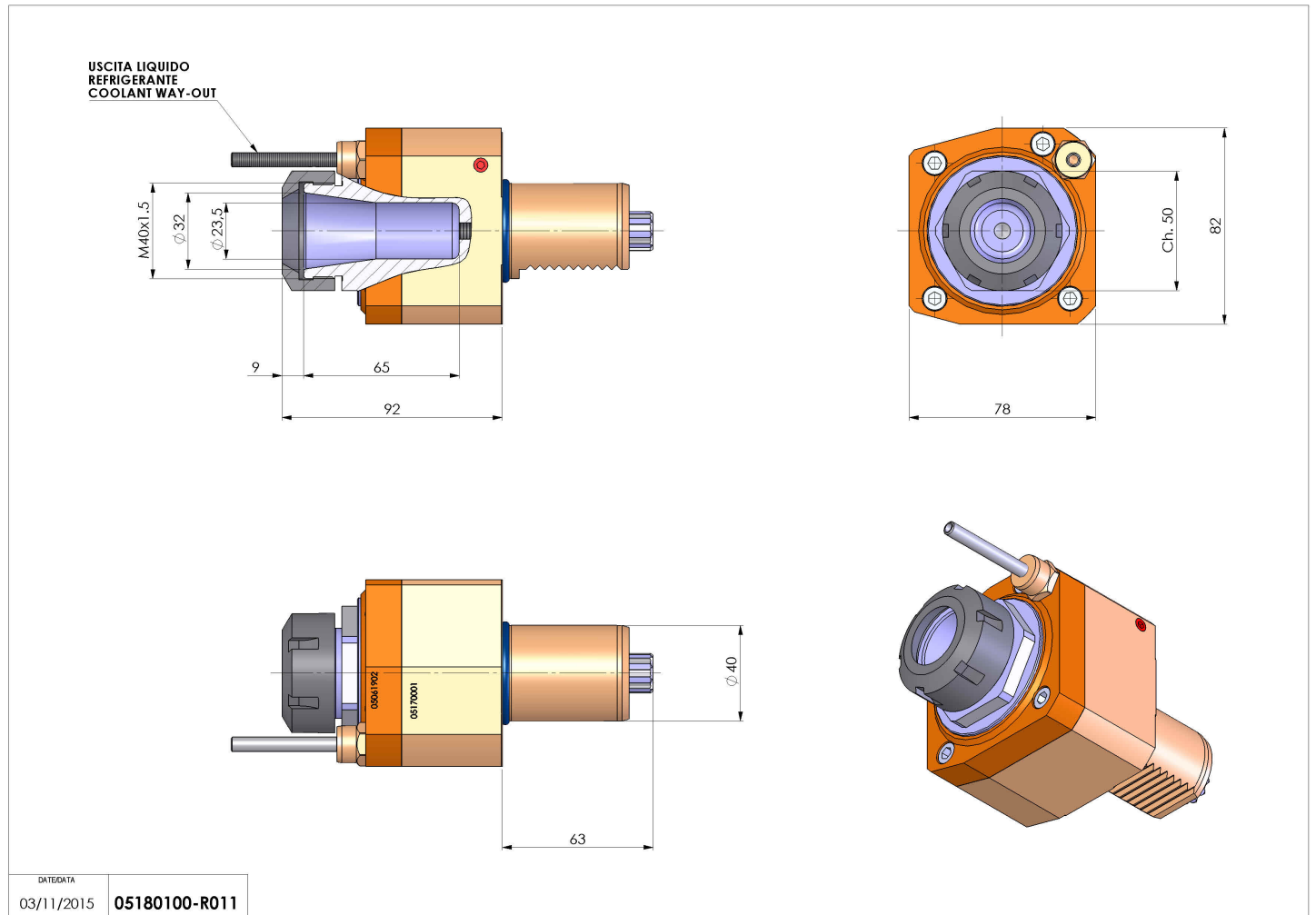

Subject to technical changes