

05161100 - LT-S D35ER20F OF38.25 1:2H95MU

| | |
|------------------------------|---|
| Type | LT-S OFS Tool holder straight offset |
| Mounting | CYLINDRICAL SHANK 35 |
| Tool output | Collet nut ER 20 F - internal nut |
| Coolant | External coolant |
| Offset [mm] | 38,25 |
| Direction of rotation | r1 ↻ r2 ↻ |
| Max speed [rpm] | in 6000 / out 12000 |
| Max torque [Nm] | in 10 / out 5 |
| Ratio | 1:2 |
| H [mm] | 95 |
| Accessories | N.A. |
| Notes | N.A. |
| Mounting tips | N.A. |

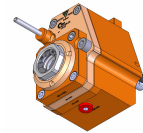

Always check live tool dimensions on the turret

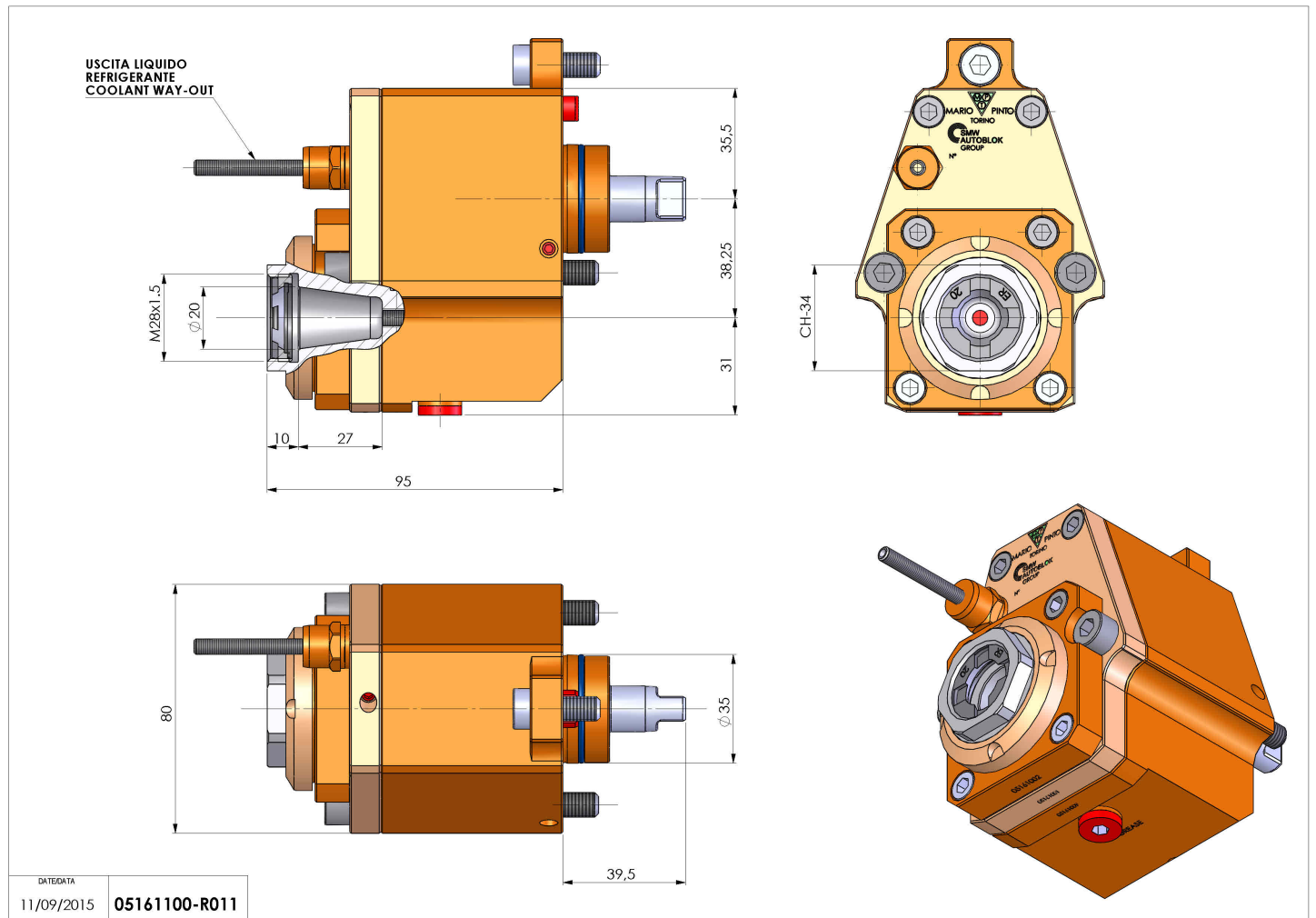

DATE/ATA
11/09/2015 05161100-R011

Subject to technical changes