

05160100 - LT-S D35 ER20F RF H63 MU

| | |
|------------------------------|-----------------------------------|
| Type | LT-S Tool holder straight |
| Mounting | CYLINDRICAL SHANK 35 |
| Tool output | Collet nut ER 20 F - internal nut |
| Coolant | Internal coolant |
| Direction of rotation | r1 ↻ r2 ↻ |
| Max speed [rpm] | 6000 |
| Max torque [Nm] | 25 |
| Ratio | 1:1 |
| H [mm] | 63 |
| Max pressure [bar] | 20 |
| Accessories | |
| Notes | N.A. |
| Mounting tips | N.A. |

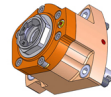

Always check live tool dimensions on the turret

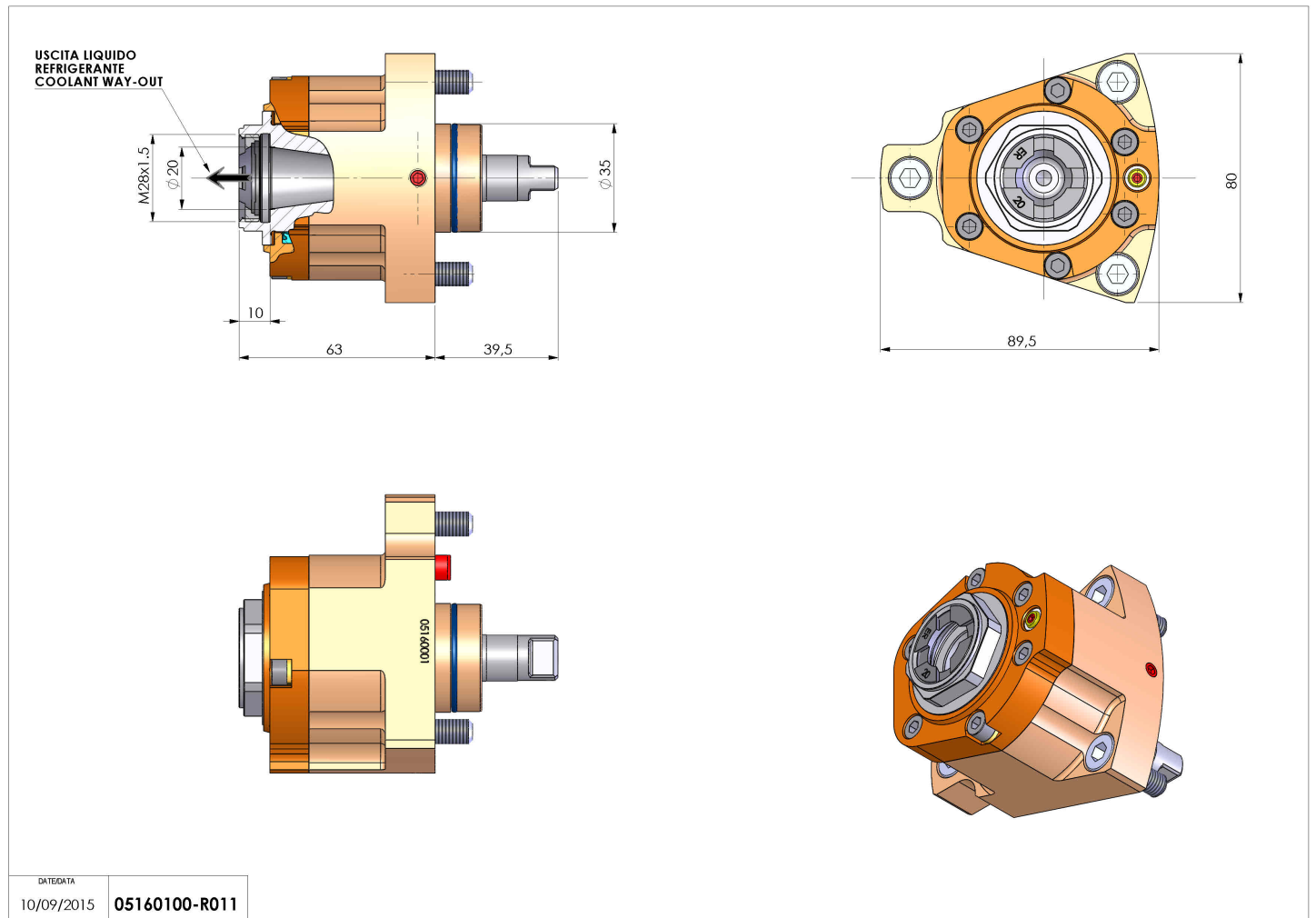

DATE/DATE
10/09/2015 05160100-R011

Subject to technical changes