

05059900 - LT-T VDI50 ER40 H75-200 MZ

| | |
|-----------------------|------------------------------|
| Type | LT-T Tool holder tiltable |
| Mounting | VDI 50 |
| Tool output | Collet nut ER 40 |
| Coolant | External coolant |
| Direction of rotation | r1 ↻ r2 ↻ |
| Max speed [rpm] | 4000 |
| Max torque [Nm] | 43 |
| Ratio | 1:1 |
| H [mm] | 75-200 |
| Accessories | N.A. |
| Notes | N.A. |
| Mounting tips | N.A. |

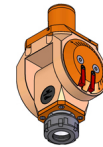

ATTENTION: CHECK THE ORIENTATION OF THE VDI TEETH

Always check live tool dimensions on the turret

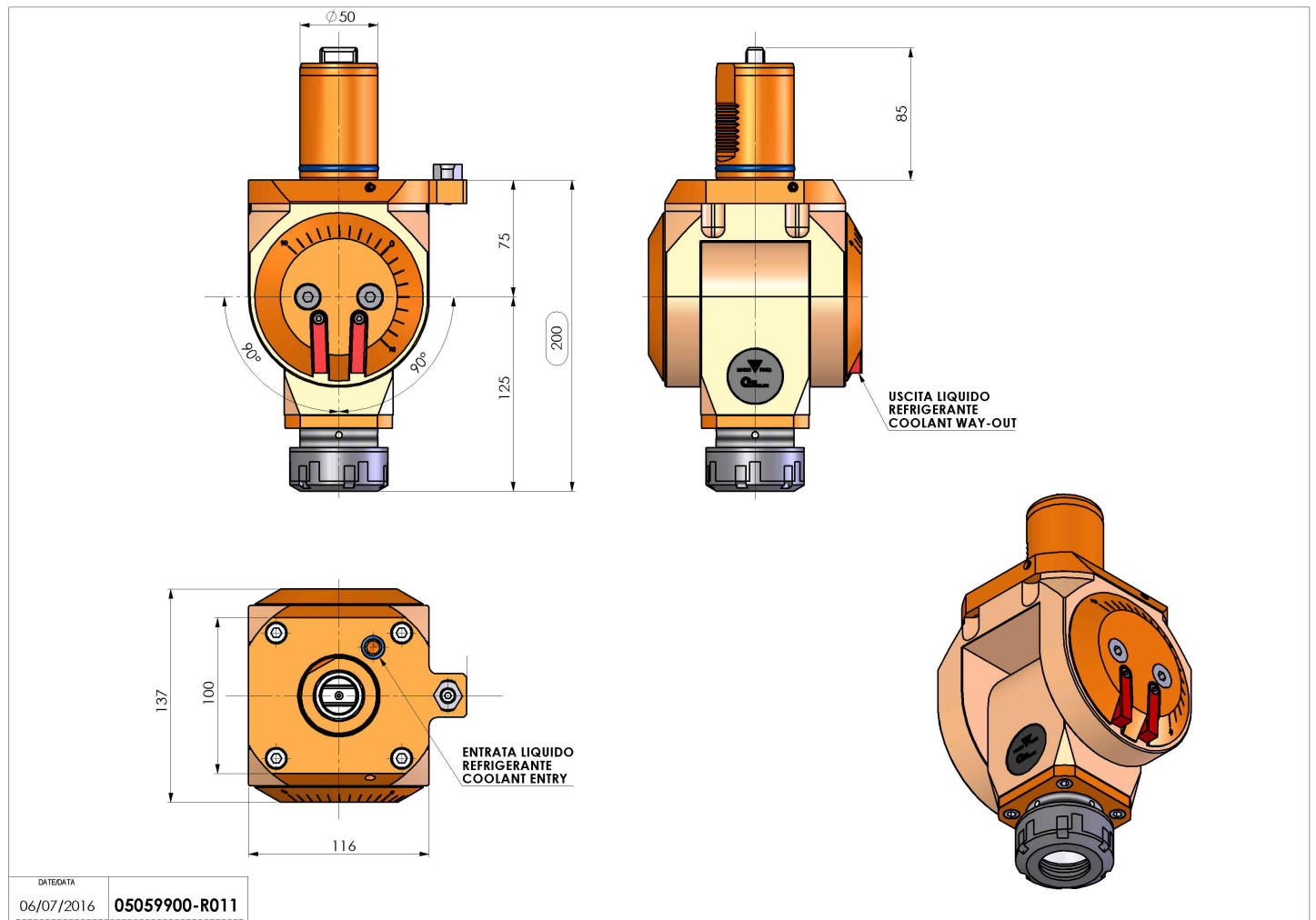

DATE/DATE: 06/07/2016
05059900-R011

Subject to technical changes