

# 0505200 - LT-A VDI40 ER32F R OFS H100 MZ

|                              |  |
|------------------------------|--|
| <b>Type</b>                  | LT-A OFS<br>Tool holder offset angle 90° |
| <b>Mounting</b>              | VDI 40                                   |
| <b>Tool output</b>           | Collet nut ER 32 F - internal nut        |
| <b>Coolant</b>               | External coolant                         |
| <b>Direction of rotation</b> | r1 ↻ r2 ↻                                |
| <b>Max speed [rpm]</b>       | 6000                                     |
| <b>Max torque [Nm]</b>       | 63                                       |
| <b>Ratio</b>                 | 1:1                                      |
| <b>H [mm]</b>                | 100                                      |
| <b>H1 [mm]</b>               | 38                                       |
| <b>Accessories</b>           | N.A.                                     |
| <b>Notes</b>                 | N.A.                                     |
| <b>Mounting tips</b>         | Secondary spindle only                   |

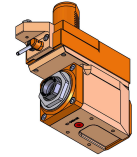

**ATTENTION: CHECK THE ORIENTATION OF THE VDI TEETH**

Always check live tool dimensions on the turret

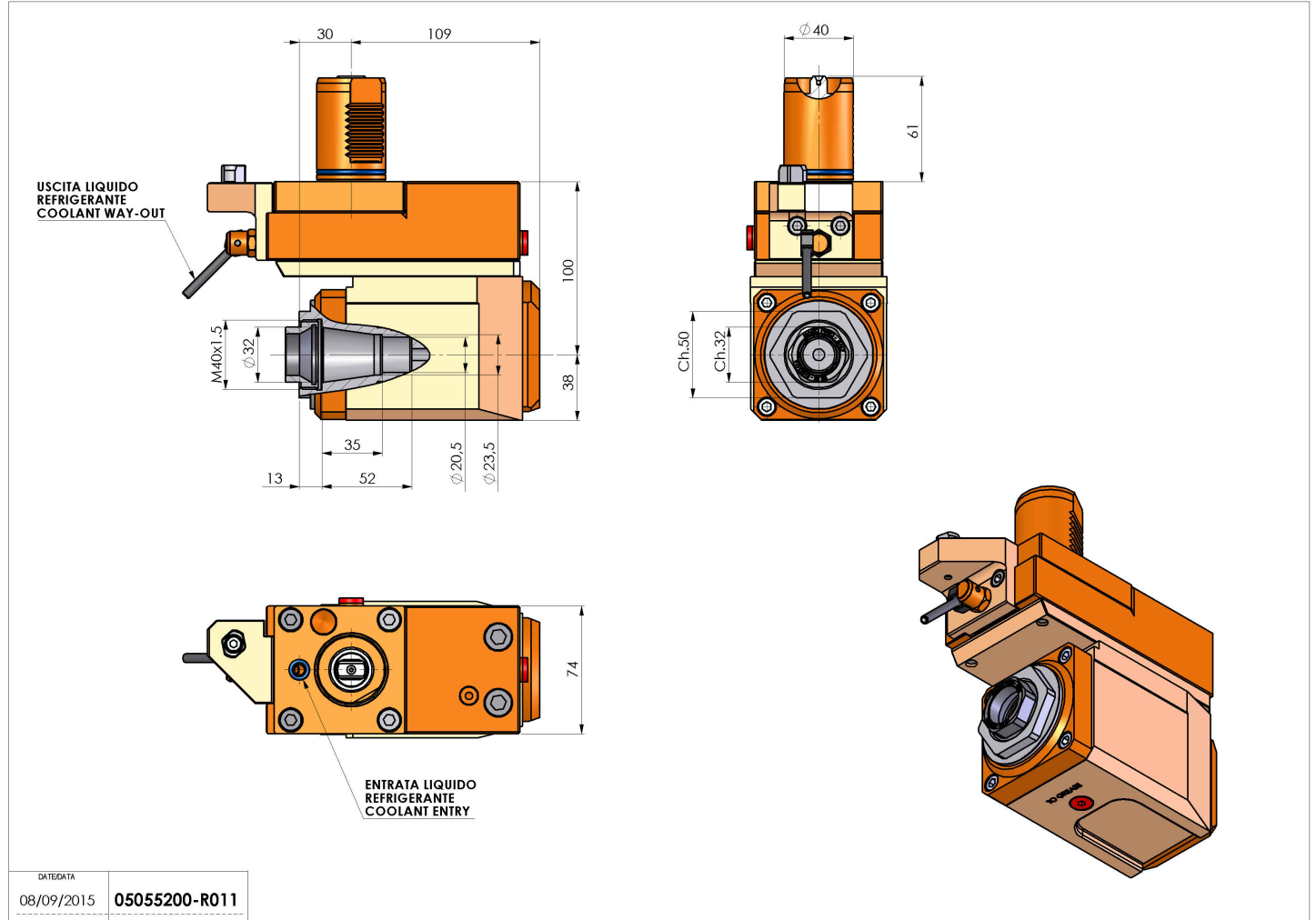

|          |            |              |
|----------|------------|--------------|
| DATE/ATA | 08/09/2015 | 0505200-R011 |
|----------|------------|--------------|

Subject to technical changes